Silicon Beach Creative Office Space

3015 Main St.
Suite 360
Santa Monica, CA

Marine St. & Main St.

Carter Crouch
cc@dynamicdevco.com
310.315.5411 ext. 127



OFFERING: Suite 360

- Total Space Available: 875 RSF
- Rental Rate: \$4.25/RSF
- Lease Type: Modified Gross
- Property Type: Creative Office Space
- Showing: By Appointment Only
- Occupancy Term: Negotiable
- Available: Now
- Parking: 3 Reserved Spaces
- Parking Rate: \$165.00

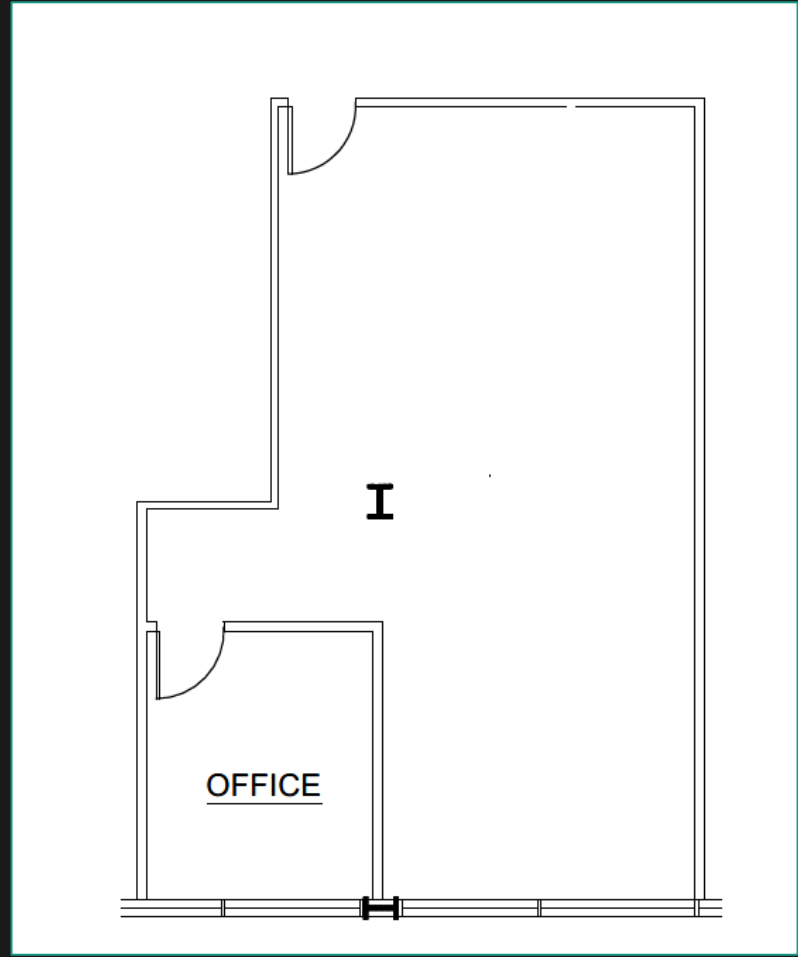

Property Vitals:

Venue adjacent in Silicon Beach at gateway to Santa Monica on Main St. & Marine St.

Steel Beamed & Modernist, campus style designed by Art Center architect.

Outdoor workspace on the expansive roof deck and patios with tables, chairs and benches that provide many options for meetings, meals or chilling.

Zen Lobby with fountain. Walls of Windows and Light with Views.

Parking areas indoors and outdoors. 24 Hour building access. On demand air conditioning. FIOS and Spectrum available. Ground floor juice bar with food.



Building Features:

Courtyard common area, rooftop deck, on site management, gated/secure parking, ground floor retail.





Nearby Features:

Neighboring tenants include Coldwell Banker Residential Brokerage, Espresso Cielo, Via Veneto, Planet Blue, Bulletproof Coffee, and Forma.

Abbot Kinney, Rose Avenue, Google, Banks, US Post Office, UPS drop and The Ocean are all in close proximity.

Area Businesses:

